

## What is in the Box?

Radio cassette recorder, mains lead, demo CD, quick start guide and safety/warranty leaflet.

### Features

- DAB / DAB+ / FM wavebands
- CD / USB bookmark remembers last played position
- MP3 / WMA playback via CD and USB
- CD syncro record - one button press starts cassette and CD
- Large easy to read LCD display with zoom function
- High visibility yellow controls
- Audible tone to confirm station found and preset memory
- 10 one touch station presets
- Rotary volume and tone control
- Ext mic and headphone sockets
- AC mains socket
- Batteries 8 x C size (LR14) not included

### Controls

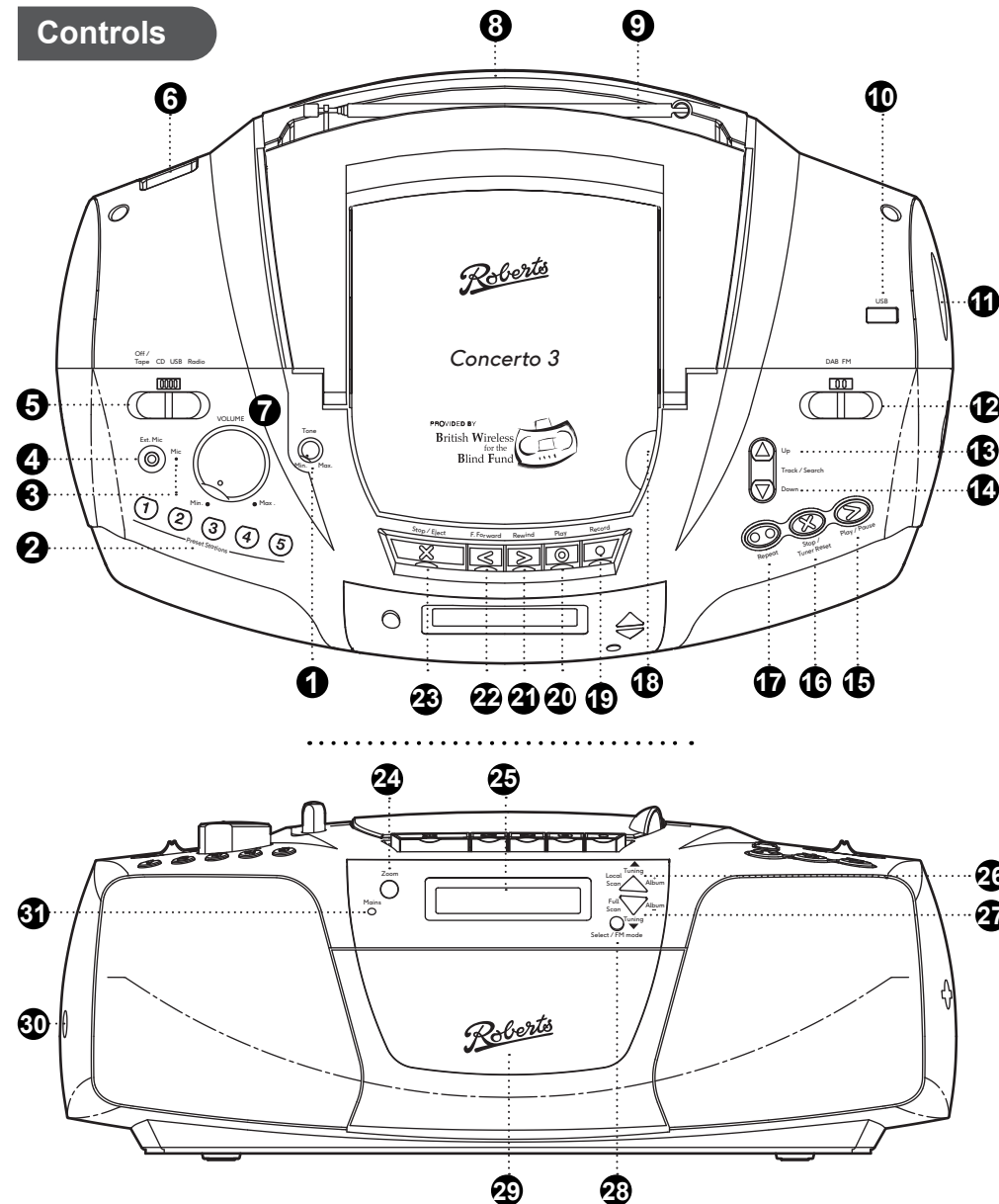

- |                                 |                               |   |
|---------------------------------|-------------------------------|---|
| 1 Tone control                  | 13 Track / Search Up button   | 25 LCD display                            |
| 2 Preset buttons 1 - 5          | 14 Track / Search Down button | 26 Tuning / Album up / local scan button  |
| 3 Internal microphone           | 15 Play / Pause button        | 27 Tuning / Album down / full scan button |
| 4 External mic socket           | 16 Stop / Tuner Reset button  | 28 Select / FM mode button                |
| 5 Function switch               | 17 Repeat / Intro button      | 29 Cassette door                          |
| 6 Mains socket                  | 18 Raised lip for CD access   | 30 Headphone socket                       |
| 7 Volume control                | 19 Record key                 | 31 Mains indicator light                  |
| 8 Battery compartment           | 20 Play key                   |   |
| 9 Telescopic aerial             | 21 Rewind key                 |   |
| 10 USB socket                   | 22 Fastforward key            |   |
| 11 Tuning assist volume control | 23 Stop / Eject key           |   |
| 12 DAB / FM switch              | 24 Zoom button                |   |

## STEP 1 - Plug in & play DAB radio

### A - Connect to the mains

Please read the safety leaflet provided before connecting your unit to the mains.

- 1 Place your CD radio cassette recorder on a flat surface.
- 2 Plug the mains lead into the **mains power socket** ensuring that the plug is pushed fully into the socket.
- 3 Plug the other end of the mains lead into a wall socket and switch on the socket. The mains LED will light and the clock will set.

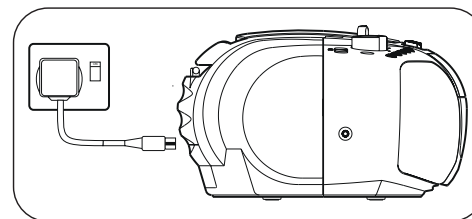

### B - Play DAB radio

- 1 Carefully, fully extend then angle the **telescopic aerial**.
  - 2 Slide the **Function** switch to the 'Radio' position. To switch off slide to 'Off'.
  - 3 Slide the **DAB / FM** switch to 'DAB'. If this is the first time the radio is used a scan of the Band III DAB channels will be carried out. If the radio is used before the last used station will be selected. If no signals are found it may be necessary to relocate your unit to a position giving better reception.
  - 4 Press the **Tuning Up** or **Down** buttons to scroll through the list of available stations.
  - 5 Press the **Select** button to tune to the chosen station. Adjust the **Volume**.
- Some radio stations may have one or more additional broadcasts associated with them. If these are available they will appear immediately after the main station.

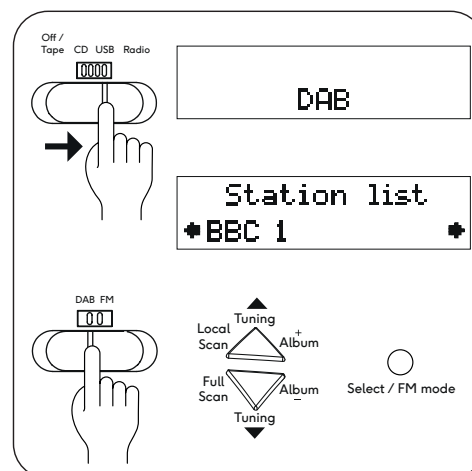

### C - Scan for DAB stations

As time passes new stations may become available. To find new stations proceed as follows:

- 1 **Apply a long press** on the **Local Scan** button. The display will show 'Scanning'.
  - 2 To carry out a full scan, **apply a long press** on the **Full Scan** button. The display will show 'Scanning'.
- As new radio stations are found the station counter will increase and the radio stations will be added to the list stored in the radio.

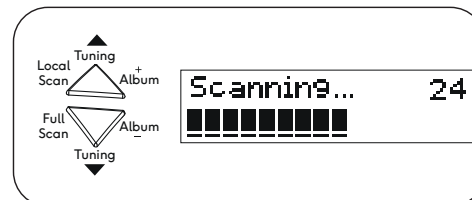

## STEP 2 - Play FM radio

- 1 Carefully, extend the **telescopic aerial**.
  - 2 Slide the **Function** switch to 'Radio'.
  - 3 Slide the **DAB / FM** switch to 'FM'.
  - 4 **Press and hold down** either the **Tuning Up** or **Down** buttons for more than 0.5 seconds to commence scan. An audible tone will be heard indicating that the radio is tuning. The tone will increase in pitch for tuning up and decrease for tuning down. The audible tone volume can be adjusted using the Tuning assist volume control on the right hand side of the unit.
  - 5 Your radio will scan the selected waveband, sound a beep tone and stop automatically when it finds a station of sufficient strength.
  - 6 Adjust the **Volume** and **Tone** controls.
- To reduce any hiss switch to mono mode. **Apply a long press** on the **Select / FM mode** button to toggle mono / stereo mode.

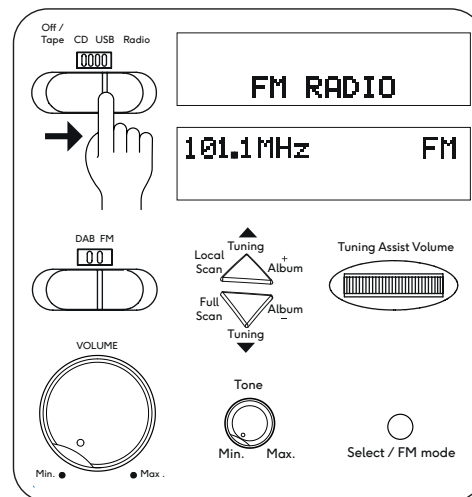

## Manual tune - FM radio

### Manual tuning - FM

- 1 Carefully, fully extend then angle the **telescopic aerial**.
- 2 Slide the **Function** switch to the 'Radio' position.
- 3 Slide the **DAB / FM** switch to 'FM'.
- 4 Press the **Tuning Up** or **Down** buttons to tune to a station. The frequency will change in steps of 50kHz.
- 5 Adjust the **Volume** and **Tone** controls. It is recommended that the DAB band be used wherever possible as better results in terms of quality and freedom from interference will usually be obtained than on the FM band.

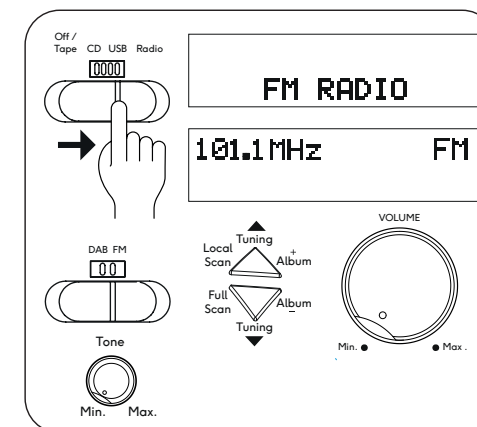

### Preset radio stations - 5 DAB, 5 FM

You may store your preferred DAB and FM radio stations to the preset station memories. Presets are remembered in the event of a power failure.

To store a station preset

- 1 Slide the **Function** switch to 'Radio'.
- 2 Slide the **DAB / FM** switch to 'DAB' or 'FM' and tune to the required station.
- 3 **Apply a long press** on the required **Preset button 1 - 5**. The display shows e.g. 'Preset 1 stored'. A beep will be heard. The station will be stored under the chosen preset. Stored presets, maybe overwritten by following the above procedure.

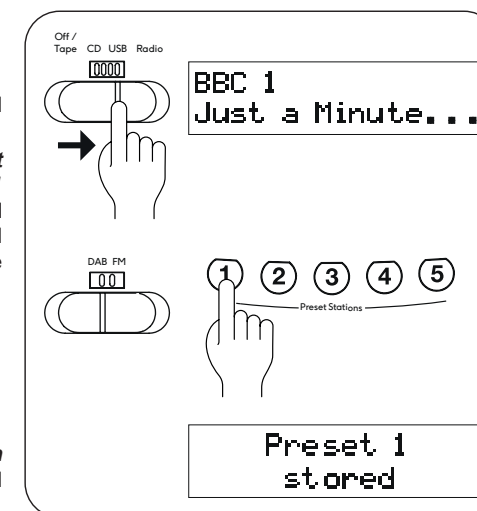

To recall a station preset

- 1 Slide the **Function** switch to 'Radio'.
- 2 Slide the **DAB / FM** switch to 'DAB' or 'FM'.
- 3 Momentarily, press the required **Preset button 1 - 5**. Your radio will tune to the station stored in preset memory.

## STEP 3 - Compact discs

For operation of your CD player please see overleaf.

Use only Digital Audio CDs which have the symbol. Never write on a CD or attach any sticker to the CD. Always hold the CD at the edge and store it in its box after use with the label facing up.

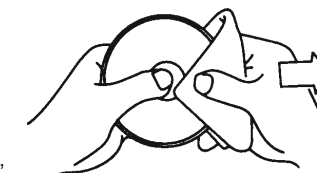

To remove dust and dirt, breathe on the CD and wipe it with a soft, lint-free cloth in a straight line from the centre towards the edge.

Cleaning agents may damage the CD. Do not expose the CD to rain, moisture, sand, or to excessive heat. (e.g. from heating equipment or in motor cars parked in the sun).

Your CD player can playback CD-DA format audio CD-R/CD-RW discs that have been finalised\* upon completion of recording. Your CD player may fail to playback some CD-R/CD-RW discs due to poor recording of the CD-R/CD-RW disc.\*Finalising enables a CD-R/CD-RW disc to playback on audio CD players such as your Concerto 3.

The Concerto 3 is able to play CD-R and CD-RW discs containing MP3 or WMA files. The CD cassette recorder reads MP3 and WMA files with a maximum of 255 files per folder. An MP3 or WMA CD may not contain more than 512 files or albums in total. MP3 or WMA files must be created with an audio sample rate of 44.1kHz (this is normal for files created from CD audio content). Both MP3 and WMA files may be recorded on to the same media.

When you are making audio CDs, observe all legal guidelines and ensure that the copyright of third parties is not infringed.

**CLASS 1 LASER PRODUCT** means that the laser's construction makes it inherently safe so that the legally prescribed maximum permissible radiation values can never be exceeded. **Caution:** Using any equipment or devices other than those described and specified in these operating instructions, or tampering with the unit in any way, can result in dangerous exposure to radiation.

**CLASS 1  
LASER PRODUCT**

continued overleaf...

## STEP 3 cont. - Play CD / CD MP3 / WMA discs

### A - Inserting a CD

- To open the CD compartment, position a finger underneath the raised lip and lift up the CD door.
- Put the CD on the spindle, print side facing upwards until it clicks into place. Gently close the CD compartment by pushing the cd door back into position.

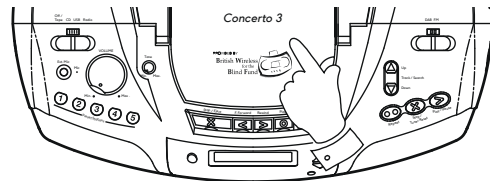

### B - Playing a CD

- Slide the **Function** switch to the 'CD' position. The CD player will scan the contents of the CD, 'READING' will appear on the display.
- Press the **Play/Pause** button to start playback and adjust the **Volume**.
- To pause or continue playback press the **Play/Pause** button.
- To stop playback, press the **Stop** button.

**Note:** The CD door should only be opened when the CD is in stop mode.

#### CD Bookmark

The CD Bookmark feature allows you to stop the playback of a CD and then to continue playback from the same point at a later time. Even if you change the function, the next CD play operation will start from the point where playback was previously stopped. Note that if mains power is removed and restored the Bookmark setting will be cancelled and the CD will then play from the beginning. When the CD is playing, press **Stop** button once. The display will show resume. You can then select an alternative function. If you wish to cancel the Bookmark function, either press the Stop button a second time when the radio is in CD mode or simply take out the CD.

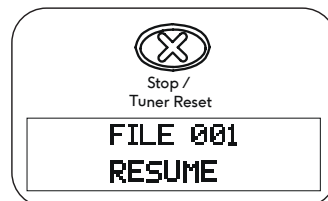
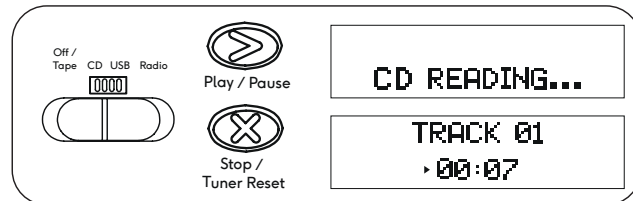

### C - Selecting a track

- Audio CD: While the CD is playing, press either the **Track Up** or **Down** buttons to change the desired track. You can also skip to a track when the player is in stop mode. Press **Play/Pause**.
- MP3 / WMA CD: While the CD is playing, press either the **Album +** or **-** buttons to change to the desired album/folder, then press **Track Up** or **Down** buttons to change to the desired track. You can also skip tracks when the player is in stop mode. Press **Play/Pause**.
- To search to the desired part of the track, give a long press on the **Track/Search Up** or **Down** buttons.

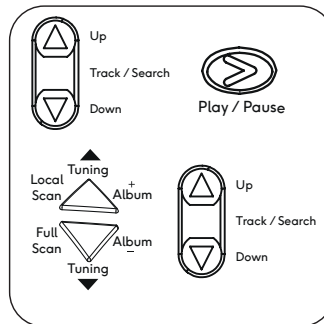

**Repeat** -To access the repeat options (repeat a track, all tracks or repeat album when playing MP3 / WMA files) whilst the unit is playing, press the **Repeat** button as required.

**Intro** - When the CD is in stop mode, press the **Repeat** button to play the first 10 seconds of each of the tracks on the disc. To cancel, press Repeat.



## STEP 4 - Play USB / Cassette tapes / Recording

Your CD radio cassette recorder can access and playback your audio files via USB memory devices.

The Concerto 3 has been tested with a range of USB memory devices up to 16GB. Memory must use the FAT or FAT 32 filing system in order to operate in the Concerto 3. **Important:** Your radio cassette player is designed to work with USB flash memory devices. It is not intended to be connected to hard disk drives or any other type of USB device. Audio formats supported on USB memory devices are MP3 and WMA. Playback does not support files encoded using WMA lossless, WMA voice, WMA 10 professional, nor files of any format which have DRM protection.

The USB socket is located on the top right hand side of the unit. Carefully insert a USB memory device into the USB socket. To remove the USB memory device simply pull the device out.

### USB mode

- Slide the **Function** switch to 'USB'.

**Note:** Playback control in USB mode is similar to CD-MP3 / WMA mode (see above). Files are played back in the order that they are written to the USB memory device by your computer.

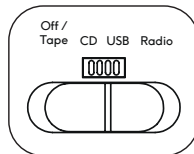

### Cassette tapes

**Note:** This unit is not suitable for recording onto CHROME (IECII) or METAL (IEC IV) cassettes. For playback any cassette type may be used.

- Slide the **Function** switch to the **Tape** position.
- Press the **Stop/Eject** key to open the Cassette compartment.
- Insert a pre-recorded cassette tape with the tape surface upwards and the side with the desired recording facing towards you. Close the compartment.
- Depress the **Play** key and adjust the **Volume** and **Tone** controls.
- Use the **Fastforward** or **Rewind** keys to locate a specific part of the tape. To stop the tape press the **Stop/Eject** key.

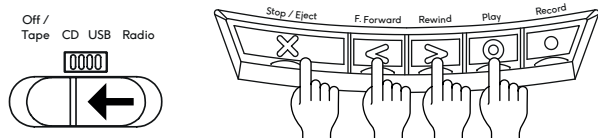

### Recording

#### Record from radio

Slide the **Function** switch to the 'Radio' position and tune into the desired station. Adjust the volume. Insert a blank tape. Depress **Record** key. The recording level is automatic and is not affected by the volume control. To stop recording press the **Stop/Eject** key.

#### Record from CD

Slide the **Function** switch to the 'CD' position. Insert a CD into the compartment. Insert a blank tape. Depress **Record** key. The CD will start automatically (CD syncro start). To stop recording press the **Stop/Eject** key.

#### Record from USB

Slide the **Function** switch to the 'USB' position. Insert a USB memory device into the USB socket. Insert a blank tape. Depress **Record** key. The USB will start automatically (USB syncro start). To stop recording press the **Stop/Eject** key.

#### Recording from the internal microphone

Slide the **Function** switch to the 'Tape' position. Insert a blank tape. Depress **Record** key. To stop recording press the **Stop/Eject** key.

#### Recording from an external microphone (not included)

When recording from an external microphone the loudspeakers remain connected for monitoring purposes. If you do not wish to hear the recording being made simply rotate the volume control to minimum. The recording level is set automatically and is not affected by the setting of the Volume control.

Slide the **Function** switch to the 'Tape' position. Insert a blank tape. Plug the external microphone into the Microphone socket. The internal microphone will be automatically disconnected. Depress **Record** key. To stop recording press the **Stop/Eject** key.

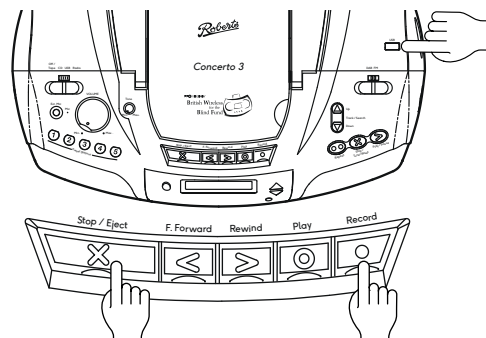

### Zoom function



Your CD radio cassette recorder has a zoom button which can be used to enlarge the size of fonts on the display. Press the **Zoom** button to enlarge the upper line of the display. Press the **Zoom** button again to enlarge the lower line. Press the **Zoom** button once more to return to the normal display.

### Cleaning tape heads

The oxide from magnetic tapes can accumulate on the pinch roller (A) the capstan shaft (B) and also the heads (C and D). This will impair the sound quality. To clean these parts proceed as follows:

- Switch off the power to the unit.
- Press the **Stop/Eject** key.
- Press the **Play** key and the heads will be clearly seen.
- Clean the surfaces (A, B, C, D) with a lint free rag or cotton swab soaked in alcohol. Press the Stop/Eject key as soon as cleaning is over.

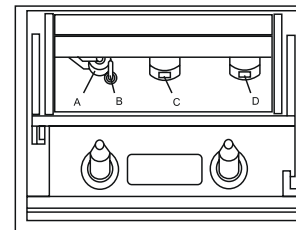

### System reset

If your CD radio cassette fails to operate correctly, or some digits on the display are missing or incomplete, carry out the following procedure.

- Slide the **Function** switch to the 'Radio' position.
- Slide the **DAB / FM** switch to the DAB position.
- Press and hold the **Stop/Tuner Reset** button to select system reset.

A full reset will be performed and the station list together with any preset stations will be erased.

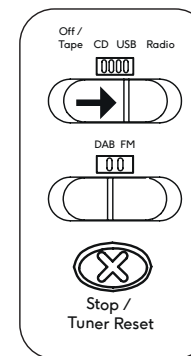

# Roberts

## Concerto 3

BWBF DAB/FM/CD/USB Cassette Recorder



Please read this guide and the safety/warranty leaflet before use

### Battery operation

Please read the safety leaflet provided before using batteries.

- Remove the Battery cover on the rear of the unit. Push the catches in the direction shown.
- Insert eight LR14 (C size) batteries into the spaces in the compartment. Take care to ensure all batteries are inserted with the correct polarity as shown inside the battery compartment. Replace the battery cover.
- Reduced power, distortion and a 'stuttering' sound are all signs that the batteries may need replacing. If the unit is not to be used for any extended period of time, it is recommended that the batteries are removed. *We would recommend for economy that the Concerto 3 is used on the mains whenever possible with battery operation for occasional or stand-by use only.*

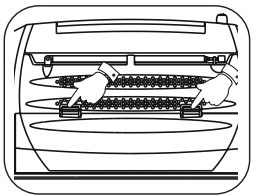

#### Cautions

In order to minimise the risk of damage to your unit, or USB memory device, please place the unit so that the device cannot be easily knocked while it is inserted in the socket.

Remove the USB memory device before carrying the unit or if not using the USB feature for a prolonged period. **Note:** The USB memory device should not be removed during playback as damage or corruption of files may occur.

**Note:** If the unit is in the CD or USB stop mode position for more than 15 minutes it will automatically switch to the standby mode. To use the unit again switch on the unit.

To safeguard your recordings against accidental erasure, break off the appropriate tab on the cassette. There is one tab for each side of the cassette. This will prevent the Record button from being pressed. To restore the cassette to normal, seal the tab openings with a small piece of self-adhesive tape.

### Headphone socket

A3.5mm **Headphone socket** is provided for use with headphones. Inserting a plug automatically mutes the internal loudspeakers. Please be aware that the sensitivity of headphones can vary widely. We therefore recommend setting the volume to a low level before connecting headphones.

### Specifications

#### Power requirements

Mains	230V ~ 50Hz only
Batteries	8 x C size / LR14 (not included)
Battery life	25 hours in CD playback mode (4 hours per day)

#### Circuit features

Headphone socket	3.5mm dia.
Microphone socket	3.5mm dia.
Aerial system	FM / DAB Telescopic aerial

Frequency coverage FM 87.5-108MHz, DAB 174.928 - 239.200MHz

#### Product markings

~ This symbol indicates AC voltage.  
— This symbol indicates DC voltage.  
The name plate is located on the underside of the unit.  
The company reserves the right to amend the specification without notice.

Designed & Engineered in the UK  
Made in China

ROBERTS RADIO LIMITED

Issue 1  
2021-12-20



www.robertsradio.com  
© 2021 Roberts Radio Limited

